

SPECIAL EDITION

# LiveWell

2015  
SUMMER ISSUE

A GENESIS HEALTHCARE SYSTEM PUBLICATION

## WELCOME TO YOUR NEW GENESIS HOSPITAL



Genesis  
HEALTHCARE SYSTEM



# CONTENTS

PAGE 4

## Innovative Approach Transforms Health Care

Learn how we found innovative ways to design the new Genesis Hospital around the needs of patients. Innovation is also on display in many new features of the facility.

PAGE 6

## Centers of Excellence Provide Specialized Care

Read about our centers of excellence and how building a new hospital gave us the opportunity to make them even better.

PAGE 8

## Maps

You'll find a campus map that shows how to find the new Genesis Hospital, along with individual floor maps so you can locate nursing units, the cafeteria and much more.

PAGE 10

## New Technology Enhances Quality and Comfort

The latest technological advancements can be found throughout the new Genesis Hospital, helping us ensure you have the highest quality of care possible.

PAGE 12

## Making History

Pictures tell the story of the historic day when all patients and services moved from Good Samaritan to the new Genesis Hospital.

PAGE 14

## Features of the New Genesis Hospital

Take a quick look at the features of the new Genesis Hospital, from the all private patient rooms, to nursing units, to the patient discharge exit, to free valet parking and much more.

# BEGINNING A NEW ERA IN HEALTH CARE



Saturday, June 27, 2015, was the beginning of a new era in health care in Southeastern Ohio as the new Genesis Hospital officially opened its doors. Now our community has a modern facility designed around the needs of patients – one that enables us to provide you with the highest quality of care. This special issue of LiveWell tells you all about the new Genesis Hospital and what it means for you and your family.

We took an innovative approach when we began planning the new facility. We talked with patients, doctors and nurses to create the ideal patient experience first. You'll find a story in this issue about how the community was involved in many steps along the way, from direct input into the design, to building mock rooms for patients to stay in and provide feedback, to using local contractors for construction.

A whole new patient experience has been created. Patients told us what mattered most to them, and we used all of this input to create our design. You'll notice the warm, welcoming atmosphere everywhere you go. From natural light streaming through windows to contemporary cafés with fresh foods – everything was designed to meet your needs.

Some simple but very important aspects of your care experience were designed right into the new hospital. Parking is easy; just pull up to the front door, and we'll park your car for you free of charge. All patient rooms are private and quiet, so you can rest. It's amazing how quiet the nursing units are because of the design.

The new hospital has the latest technology so you don't have to travel far from home to get the most advanced care. We have specialized services in areas such as cancer care, emergency and trauma, heart and vascular, neuroscience and orthopedics, and women's care. We also built a new medical office building that's connected to the new hospital. The building houses our new Heart & Vascular Center and new Neuroscience & Orthopedic Center – both provide a one-stop shop for your care needs.

Your health care is about much more than a building. The new hospital was designed in a way to enable physicians and staff to be more efficient in your care. Now they have more time to give you the most compassionate, quality care possible. Our vision is to be a health care team that exceeds your expectations when you come to us for your and your family's care. Your new Genesis Hospital will help us realize that vision.

Matthew J. Perry

President & CEO



# YOUR NEW GENESIS HOSPITAL

You've seen the changes from the outside. Now you can feel them from the inside. Every design detail of your new Genesis Hospital was planned around the needs of patients. First we worked with former patients to decide the best way to care for patients ... and then we designed the hospital to match.

This special edition of LiveWell is dedicated to your new Genesis Hospital. You'll read about the innovative approach we took when designing the new hospital, the new technology that enables us to provide high-quality care, and how the new hospital enhances our centers of excellence. You can also catch a glimpse of the day we moved all patients from Good Samaritan to the new hospital. You'll find a map that to help you find us as well.

As you read through this special edition, you'll notice some design features like the fact that all patient rooms are private, that sunlight streams through the plentiful windows, and that the finishes are bright and new.

What is not as easy to see is how we carefully thought through the location of services to minimize how far patients have to be moved. We found a way for most patient moves to occur "behind the scenes" – out of the view of the public. We also designed our nursing units to enable our nurses and other caregivers to spend more time with patients. Within each area, we've placed features to help our caregivers provide timely, consistent patient care.

We traveled around the country visiting new hospitals to learn about the best design features and ways to care for patients, and we brought the best ideas home to you ... so you don't have to leave home for high quality care.

# WELCOME TO NEW PHYSICIANS

We are pleased to welcome the following physicians to the Genesis Medical Staff:



**Megan Barnes, M.D.**  
*Hospital Medicine*

Dr. Barnes joined Genesis Inpatient Specialists as a hospitalist. Dr. Barnes earned her medical doctor degree at Northeast Ohio Medical University in Rootstown, Ohio, and completed her internal medicine residency at The Ohio State University Medical Center in Columbus, Ohio.



**Trevar Chapmon, M.D.**  
*Physical Medicine and Rehabilitation*

Dr. Chapmon is a physiatrist who joined the Genesis Physical Medicine Group. He earned his doctor of medicine at the University of South Carolina School of Medicine in Columbia, South Carolina. Dr. Chapmon completed a 1-year internship in family practice at University of Tennessee at Chattanooga Erlanger Hospital and a 3-year residency training program in physical medicine and rehabilitation at University of Alabama at Birmingham Spain Rehabilitation Center. He is board-certified by the American Board of Physical Medicine and Rehabilitation. His office is located at 955 Bethesda Drive, Physician Pavilion, garden level, and his phone number is (740) 454-4524.



**Charley Gates, M.D.**  
*Orthopedic Surgery*

Dr. Gates joined the Genesis Orthopedic Group. He earned his doctor of medicine from the University of Pittsburgh School of Medicine in Pittsburgh, Pennsylvania. Dr. Gates completed his residency in orthopedic surgery at the University of Pittsburgh Medical Center in Pittsburgh. His office is located at 955 Bethesda Drive, Physician Pavilion, garden level, Suite D, and his phone number is (740) 586-6828.



**John R. Raabe, M.D.**  
*Cardiology*

Dr. Raabe recently joined the Genesis Medical Staff and is practicing at the Genesis HealthCenter-Perry County. He earned his doctor of medicine from The Ohio State University. Dr. Raabe completed a 3-year residency training program in internal medicine at Mount Carmel Medical Center, and a 3-year fellowship in cardiovascular diseases at the Graduate Hospital in Philadelphia. Dr. Raabe is board-certified by the American Board of Internal Medicine in cardiovascular disease. His office is located at 103 Mike Clouse Drive, Somerset, Ohio, and his phone number is (740) 743-3800.



# INNOVATIVE APPROACH TRANSFORMS HEALTH CARE

We took an innovative approach in designing the new Genesis Hospital. We sat down with patients, nurses and doctors to find out the best way to care for you. The new hospital started with a plan for patient care and became a health care facility rather than the other way around.

## In the Beginning

To find out how to provide a phenomenal patient experience, hundreds of community members shared their ideas through focus groups held throughout the community. Our doctors, nurses and administrative staff traveled to 25 hospitals across the country to bring the best processes, designs and technology and ideas home to you. We found the best ways to care for you and brought them back home to create a new hospital that's built around your needs.

## A Model Idea

After the basic plans were in place, contractors were invited to vendor fairs held throughout the region to explain the bid process. Then we did something few hospitals have done – we built two model patient rooms so doctors, nurses, patients, visitors and families could offer feedback on the design – before more than 200 rooms were built in the new hospital. Staff and physicians toured the rooms and provided feedback on the design/layout.

About 100 patients stayed in the model rooms and told us what they liked – and didn't like – about the rooms. The model rooms allowed us to make hundreds of tweaks during the design phase, avoiding costly changes later. The changes were made, and the two model rooms are now a part of the orthopedic unit in your new hospital.

Similar test runs were done by clinical staff. Design teams for the operating and trauma rooms used virtual reality equipment to see how their planned designs would work. During the sessions, users could actually see and move lights and monitors to make sure everything was in the right place for patient care. The virtual reality technology enabled them to do a lifelike review without the cost of creating fully equipped operating rooms.

Before the new Genesis Cancer Care Center was built, patients provided input also. Model infusion pods for chemotherapy were tested before the final plan was complete. Each pod at the Cancer Care Center is designed like private first-class airline seating, and each has a calming view of the scenic fitness trail.



Model Inpatient Room



Infusion Pod



Patient Server

## Ask and You Shall Receive

A feature community members most often requested was private rooms. We delivered on this as each patient room in the new Genesis Hospital is private. All the inpatient rooms have private bathrooms with a shower. There's also space in the rooms for family, so they can be nearby.

The design and features of the rooms enable doctors and nurses to care for you in a different way than we've been able to do in the past. Nurses' stations were designed to be close to patients throughout the facility.

Patient rooms have patient servers built into the room. Each one is stocked with supplies so nursing staff don't need to leave the room – giving them more time to spend with patients. These patient servers are stocked from outside the room to minimize noise and interruptions for patients and families. Noise is also minimized by each patient room being inset from the hallway.



Cancer Care Center

## And Then There Was Light

One of the first things you'll notice when you enter your new Genesis Hospital is the natural light flowing through the windows to create a warm, welcoming and healing atmosphere. The indoor and outdoor spaces connect with garden areas.

We've concentrated on bringing a continuum of care under one roof. Walkways connect areas of the new hospital; the Genesis Cancer Care Center connects to the hospital, and the new medical office building connects to the Physician Pavilion and the hospital to make it easy to move from place to place.

Everything from the entrance to the exit was designed with your needs as the priority. In the new hospital there are separate discharge elevators. You'll leave the hospital from a separate exit where your loved ones can drive up to the patient discharge exit. You won't have to walk through the main lobby to go home.

The on-stage/offstage design concept is patterned after Disney theme parks. In the new hospital design, transport and staff functions are separate from patient areas to promote healing. The flow of the hospital has been redesigned to enable specialists from various areas to collaborate on care. For example, Pediatrics is near the Emergency Department (ED) so specially trained nurses can promptly care for children coming into the ED.

We've re-created how we care for patients to provide an exceptional experience. There are hundreds of new processes. An example is multidisciplinary rounding. Everyone involved in patients' care – from the pharmacist to the social worker – meets frequently to discuss the plan of care for each patient.

We built more than a new building.

We've rebuilt the way we care for you to create an **exceptional patient experience** at the new Genesis Hospital.



# CENTERS OF EXCELLENCE PROVIDE SPECIALIZED CARE

Genesis has centers of excellence to focus high-quality care around specific health conditions and needs. We had an opportunity to enhance the centers of excellence when we built the new Genesis Hospital. By bringing services together in one hospital and designing the flow of care first, patients and their families have a better overall experience.



Holly McAllister  
Cancer Patient

## Cancer Care

Genesis Cancer Services has a team of specialists and state-of-the-art technology and is accredited and recognized by leading national organizations. The compassionate team provides high-quality cancer care along with the support patients need as they cope with the physical and emotional challenges a cancer diagnosis brings.

The new Genesis Cancer Care Center started with a plan to create an ideal patient experience, then it became a building – instead of the other way around. A complete team dedicated to cancer care is under one roof. Physicians, pharmacists, nurse navigators, specialists in palliative care and spiritual care surround our patients and their families in this comforting and healing environment. Financial counselors are available onsite to help relieve the stresses related to the high cost of cancer care.

The new center also has the latest technology advances, including the TrueBeam linear accelerator which can deliver precise radiation therapy treatments over a short time. This advanced radiation machine was previously only available at the largest medical centers.

Our chemotherapy suite features the latest in architectural design with innovative treatment pods that promote privacy and comfort and a glass wall overlooking the fitness trail. These features come together to create a peaceful, healing environment for our patients undergoing cancer treatments.



Trauma Bay

## Emergency & Trauma Services

Genesis is a Level III trauma center. Our accredited facility has an integrated team specially trained to treat critical injuries. The team includes emergency physicians and surgeons with special training and expertise in trauma surgery – neurosurgeons, orthopedic surgeons and general surgeons, as well as anesthesiologists and highly trained and experienced nursing staff. Without this advanced care closer to home, patients would have to be transported far from home. Time is crucial in a traumatic injury: the faster the treatment, the greater the likelihood of having a good outcome.

The Emergency Department (ED) in the new hospital has 49 rooms, including 40 exam rooms, three trauma rooms and six basic care rooms. This is double the size of the previous ED. There are separate entrances – one for walk-in patients and another for ambulances.

The new ED also has a CT scanner and X-ray equipment in the department to reduce time transporting patients to another area for imaging and to speed up testing time and results. Next to the ED is a new observation unit with 20 patient rooms. The unit provides dedicated space for patients to receive additional testing and diagnosis to determine if an inpatient hospital stay is needed.



EP Lab

## Heart & Vascular Services

You don't have to travel far from home for a full range of heart care services. The quality at Genesis is among the highest in the state and country for heart attack and heart failure. We were the first hospital in the nation to receive Atrial Fibrillation Certification from the Society of Chest Pain Centers (SCPC); the first hospital in Ohio and one of 18 hospitals nationwide to receive full Heart Failure Accreditation; and the first and only health system in southeast Ohio to become a fully accredited Chest Pain Center with PCI (percutaneous coronary intervention) or angioplasty.

In the new hospital, cardiovascular services are all located in one area including imaging services to enable quicker testing. There are three new cardiac catheterization labs and an electrophysiology (EP) lab. There's also a hybrid operating room that can be quickly transformed to accommodate minimally invasive procedures or life-saving operations, such as open heart surgery.

Our new Heart & Vascular Center has our cardiology physicians and an outpatient diagnostic testing center. It also includes a clinic focused on congestive heart failure and device management. The center is conveniently located in the Physician Pavilion.

## Neurosciences

If a family or friend is having a stroke, time is crucial. We've met quality measures to diagnose and treat stroke patients. Genesis achieved the Get With The Guidelines®-Stroke Gold-Plus Quality Achievement Award. Neurosciences also received Primary Stroke Certification from the Healthcare Facilities Accreditation Program (HFAP) for meeting national standards for patient safety, quality improvement and environmental safety. Our physicians are board-certified in neurological surgery, neurology, clinical neurophysiology and sleep medicine, and physical medicine and rehabilitation. Genesis Hospital has a trained critical care or acute care physician always in-house to promptly treat neurological conditions.

## Orthopedic Care

Orthopedics is on the first floor of the new Genesis Hospital for easy access. There are 20 inpatient rooms with specially trained nurses. Caregivers provide additional education to ensure your family and friends have the information they need to get back to enjoying life. Dedicated case managers develop a plan for care along with patients undergoing total joint replacements. The plan includes care while they're in the hospital and after they arrive home.

### Neuroscience & Orthopedic Center

The Neuroscience & Orthopedic Center brings together our neurosurgeons, neurologists, orthopedic surgeons, physical medicine and rehabilitation physicians, and pain medicine physicians along with specialized therapies in one convenient location. There's also a new therapy gym next to the Neuroscience & Orthopedics Center expected to be complete in 2015.



Pediatric Play Room

## Women's Care

We have a wide range of specialized care available for women of all ages and stages of life. The expert care includes an experienced team of doctors and nurses to guide and support mothers during pregnancy and through childbirth. If a newborn needs advanced medical care, we have the highest level of care in southeastern Ohio with a Level II Neonatal Intermediate Care Unit (NICU). The unit is certified by the Ohio Department of Health.

In the new nursery at Genesis Hospital, there's state-of-the-art technology, including a GPS location system with perimeter detection. The system automatically locks the doors, if an infant is transported near any open access route, including doors, stairwells and elevators.

The new hospital has a pediatric unit near the ED with six rooms, so specially trained nurses can help children who come to the ED. This is one of the few dedicated inpatient pediatric and adolescent units in southeastern Ohio.

Our women's care services also includes specialists in gynecological care.

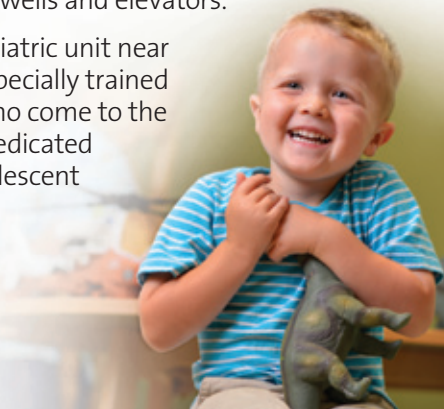



8 GENESIS HOSPITAL CAMPUS

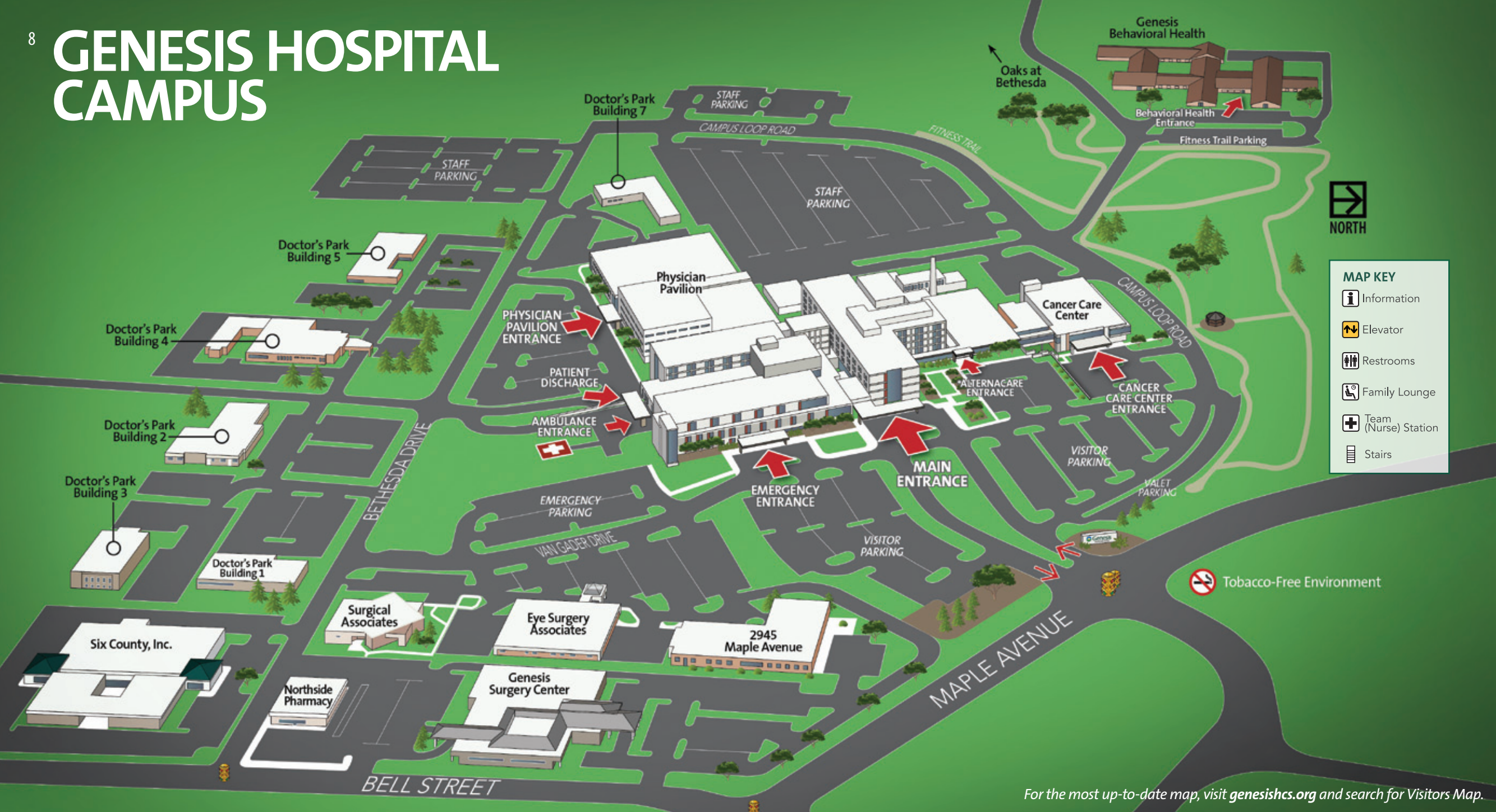

For the most up-to-date map, visit [genesishcs.org](http://genesishcs.org) and search for Visitors Map.

DEPARTMENT FLOOR

*AlternaCare	.....	1
*Audiology	.....	G
Cancer Care Center	.....	1
Cancer Care Center Registration	.....	G
Cancer Care Unit	.....	4
Patient Rooms 4131-4140	.....	
Cardiovascular Intermediate Care Unit (CVIU)	.....	3
Patient Rooms 3201-3224	.....	
*Chapel	.....	1
Conference Center	.....	G
Critical Care Unit Patient Rooms 3241-3264	.....	3
Diabetes Management & Nutrition Education	.....	3
*Dialysis	.....	1
Emergency Registration	.....	1
*Endoscopy	.....	1
Garden Café	.....	G
*Gift Shop	.....	1
Heart & Vascular Center	.....	1
Heart & Vascular, Pulmonary Gym	.....	G
Imaging	.....	1
Infusion Center	.....	1
*Jazzman's Café	.....	G
Lab	.....	G
Lab Draw	.....	G
*Lobby Bistro	.....	1
Maternity	.....	2
Patient Rooms 2101-2169	.....	
Medical/Surgical	.....	3
Patient Rooms 3101-3171	.....	
Medical/Surgical Step-down Unit	.....	3
Patient Rooms 3131-3140	.....	
Medical/Surgical	.....	4
Patient Rooms 4101-4224	.....	
Meeting Rooms A-D	.....	G
Northside Pharmacy	.....	G
Observation Unit Patient Rooms 1201-1221	.....	1
Neuro/Ortho Center	.....	G
Ortho Unit Patient Rooms 1101-1120	.....	1
Patient Discharge	.....	G
Patient Registration	.....	1
Pediatrics Patient Rooms 1391-1396	.....	1
Physician Pavilion Suites 110, 120, 130, 140	.....	1
Physician Pavilion Suites	.....	2
200, 220, 230, 240, 260	.....	
Physician Pavilion Suites 300, 330	.....	3
Pre-Admission Testing	.....	1
Pre & Post Op	.....	2
Patient Rooms 2201-2230	.....	
*Spiritual Care	.....	1
Surgery	.....	2
Wound Care Center	.....	G

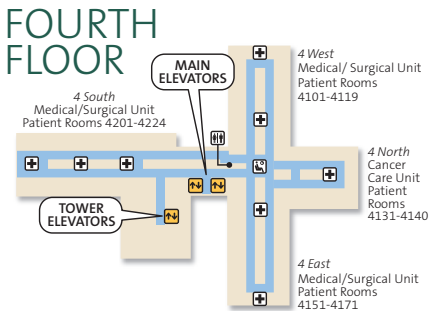
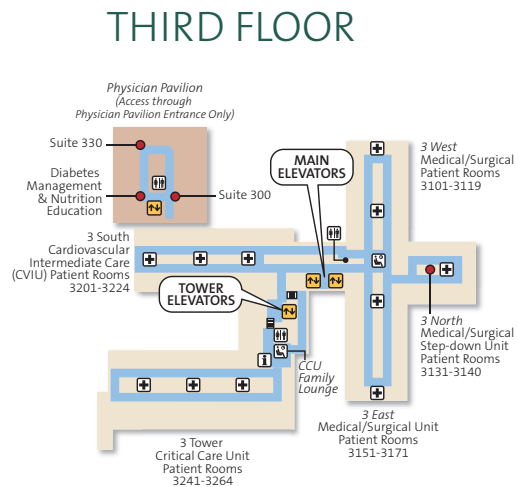
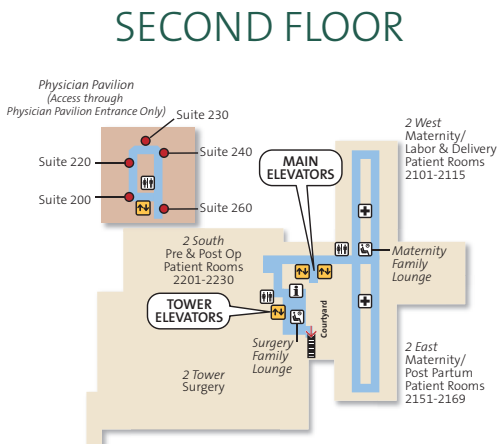
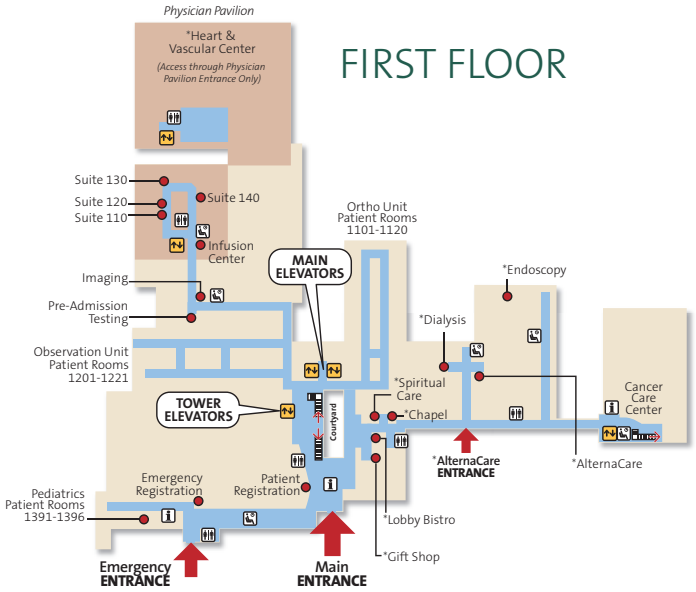
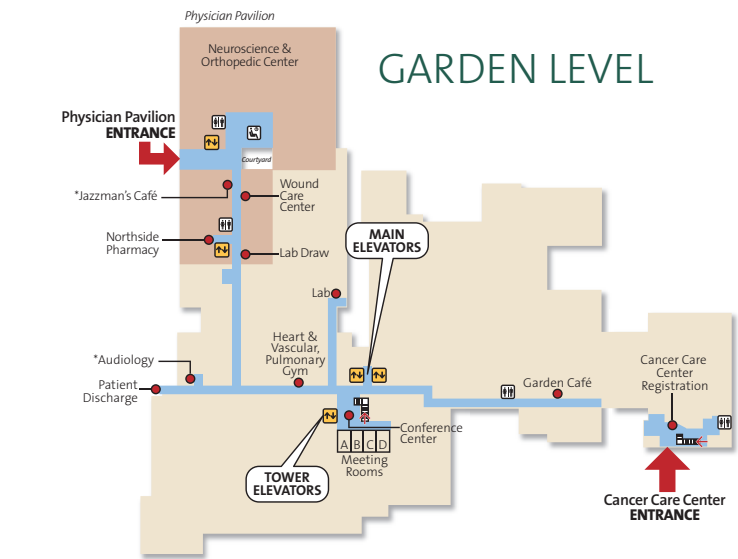



# NEW TECHNOLOGY ENHANCES QUALITY AND COMFORT

Your new Genesis Hospital includes new equipment that uses the latest technologies to ensure you and your family receives the best possible care. Take a look at where you'll find technological advancements.

## Imaging Technology

The Imaging department in the hospital has new, leading-edge technology. From X-rays to MRIs, the equipment is designed to keep you comfortable, obtain accurate results, and get you back to enjoying life as soon as possible.

### X-ray Advancements

One of the first things you'll notice with the new technology is the faster processing. The new digital X-ray equipment processes images in about six seconds – without the technologist leaving the patient. The older technology took about 5 minutes and used a digital cassette that required the technologist to leave the room to process the images.

### Magnetic Resonance Imaging (MRI)

State-of-the-art MRIs provides additional space to allow patients to be more comfortable during the scan. It's quieter than the older technology and even has a "whisper mode."

The new MRIs have excellent image quality, and enables technologists to take full images of the spine and body. The table on the new imaging equipment raises and lowers to adjust to the patient's height and can accommodate weights up to 550 pounds.

### Nuclear Imaging

Our new nuclear imaging equipment is quicker, quieter and open on all sides to make you as comfortable as possible. The new equipment is able to produce an image with half the radiation dose or half the time – depending on the patient's need. Sharper images with more details are able to be produced.

### Linear Accelerators

The Genesis Cancer Care Center has two new TrueBeam linear accelerators that offer the very latest radiation treatments with little or no wait time. These treatments include high-dose hypofractionated radiation, which compresses your treatments into just a few visits rather than many days in a row.



MRI



Linear Accelerator



Hybrid Operating Room

## Surgery

The surgery area has the most current technology available. The operating rooms are double the size of previous operating rooms and have fully automated video and audio systems that enable the entire surgical team to see and hear procedures.

A hybrid operating room features highly sophisticated imaging technology and can be quickly transformed to accommodate minimally invasive procedures or life-saving operations, such as open heart surgery, to save time and lives.

A central sterile area with a sophisticated system for sterilizing surgical equipment is an important part of surgery. Surgical instruments are sterilized in a unit about the size of an elevator, similar to a small car wash. The process is faster, more efficient and lessens how often the instruments have to be handled.

The overall design of the surgery area allows for quick and easy movement of patients from one area to another and maintains patients' privacy – all patient movement is "behind-the-scenes" and out of the view of visitors. Elevators within surgery provide a direct route to the critical care unit located one floor above, and to the central sterile area, located two floors below. The pre- and post-surgery unit is next to the operating rooms.

## Modern Patient Communication

The patient rooms in the new hospital are designed with advanced technological features to provide the best care possible. A new nurse call system can be programmed specifically for your needs. For example, the call system can include a yellow light to alert nurses that there's a possible fall risk. The system can be programmed with about 50 different alerts.

Telemetry, with the ability to transmit and collect data from patient monitors, has extended coverage throughout various areas of the hospital. A cardiac patient can continue to be monitored while moving to another part of the hospital for tests.

## Information Technology (IT)

The new Genesis Hospital has sophisticated redundancy built into its computer system to ensure care isn't interrupted by power outages. The new system includes backups to the backup systems.

Another innovative feature is that patient monitors integrate directly into the electronic medical records. The direct link increases accuracy, reduces the time required to enter information, and enables nurses to spend more time providing one-on-one care.



# MAKING HISTORY

## Move Day – June 27, 2015

June – a month for graduations, vacations and lazy summer days. Except for the team at Genesis HealthCare System, as we were busy planning for the move to the new Genesis Hospital. Three mock moves were held to prepare for the big day, and the planning paid off as 91 patients were safely moved from Good Samaritan to the new hospital in one day. Take a look behind-the-scenes to see what happened on June 27.



### Before the Sun Was Up

Howard Watson is one of the first patients to move from Good Samaritan at 6:30 a.m. He was surrounded by caring staff who were by his side throughout the day.



### Ready to Go

Ambulances were lined up and ready to move patients from Good Samaritan to the new hospital. An ambulance left Good Samaritan an average of every 4.2 minutes for the two-mile trip to the new hospital.



### Teams in Place

Doctors, nurses and staff were ready to cover every detail to ensure patients were moved safely from Good Samaritan to the new Genesis Hospital. Staff in central command stations at each hospital guided the move and constantly communicated by radio.



### Ready and Waiting

Gabe Romero and Elizabeth Ballantine, Community Ambulance Service, were part of the team that provided expert transportation and care. Every detail was planned to ensure patients were transported smoothly – from hallway monitors directing traffic in the hallways at Good Samaritan to policemen directing traffic on Zanesville streets for the ambulances.



### A New Era

Sign company workers remove the Emergency Department (ED) sign at Good Samaritan. The new ED, twice the size, opened at 6 a.m. at the new Genesis Hospital.



### On Track

Dawna Lee and Amanda Shaner were part of the team who tracked the progress of each patient and made calls to patients' families to let them know the status of their loved ones throughout the day. Months of planning went into move day with help from an outside company specializing in hospital moves.



### Expert Staff Ready

Genesis staff welcome and provide care to patients in the new Genesis Hospital. Pictured left to right are Christy Cooper, Erika Ikey and Tisha Babcock.



### Welcome Team

Sue Wolf and Sandy Cavinee were among the volunteers and employees who delivered fresh flowers to patients on move day. Along with the flowers, each patient also received a gift bag.



### Garden Café Open for Business

The completely renovated cafeteria – called the Garden Café – opened on move day. Along with desserts, the café features hand-tossed salad, a pizza oven, world cuisine and a deli counter. Food and Nutrition Services also provided meals to patients as they arrived at the new hospital on move day.



### Feeling at Home

Howard Watson offers a thumbs-up sign of approval as he comfortably settles in his private room at the new hospital. "Whoever planned this had knowledge of what to do," Howard said with a smile. "It went really well. It's very nice, and the staff has been here to help me with anything I need."



# FEATURES OF THE NEW GENESIS HOSPITAL

Every design detail of the new Genesis Hospital was planned around the needs of patients, and in each area, we've placed features to help our caregivers provide timely, consistent patient care. See what's inside the new Genesis Hospital.



Main Entrance

## Free Valet Parking

Just drive up to one of three entrances at the new hospital, and let us park your car for you, free of charge. Valet parking is available at the Main Entrance as well as the entrances to the Cancer Care Center and the Physician Pavilion.



Emergency Entrance

## Emergency Department

- 49 treatment rooms, including three state-of-the-art trauma rooms, a full-service major medical suite and specialized areas for psychiatric and OB/GYN patients
- Increased privacy – all rooms have doors instead of just curtains
- Separate basic care area for the treatment of minor illnesses or injuries
- Expanded family lounge
- In-department CT scanner and radiology suite, allowing for tests to be completed quickly and eliminating the need to move patients outside of the department
- Elevator that takes patients directly to surgery and the critical care unit



Patient Room

## All Private Patient Rooms

All inpatient rooms are private and include zones for the patients, visitors and staff.



Operating Room

## Surgery

- 12 operating rooms, including a hybrid and two cardiovascular operating rooms
- The hybrid room can be quickly transformed for minimally invasive procedures or life-saving operations.
- A central sterile area with a sophisticated system makes sterilizing surgical equipment more efficient.
- Elevators within surgery provide a direct route to the critical care unit, ED and the central sterile area. The pre- and post-surgery unit is next to the operating rooms.
- Additional features include a minor procedure room, 13 post anesthesia care rooms (PACU), 30 pre- and post-surgery rooms, 3 cardiac catheterization labs and 1 EP (electrophysiology) Lab.



Garden Café

## Garden Café

The Garden Café offers visitors a wide selection of delicious meals. By the year's end, visitors will also be able to enjoy food selections from the Lobby Bistro and Jazzman's.



Cancer Care Center Lobby

## Cancer Care Center

The center connects to the main hospital, includes unique chemotherapy pods, large floor-to-ceiling windows, a pharmacy and two new linear accelerators.



St. Francis Chapel

## St. Francis Chapel

Located on the first floor, the St. Francis Chapel will open later in the year to people of all faiths for prayer and reflection.

## Patient Discharge

When leaving the hospital, you will be moved out of the view of visitors to a discharge exit on the south side of the hospital.

## Imaging

- Advanced technology delivers up to 60 percent less radiation.
- New X-ray equipment and MRIs produce images faster.
- Nuclear imaging testing produces sharper images and is quicker, quieter and more comfortable than ever.

## Neuroscience & Orthopedic Center

Located within the Physician Pavilion, this new center brings together our neuroscience and orthopedic team with specialized therapies.

## Heart & Vascular Center

This center includes our cardiology physicians, outpatient diagnostic testing center and a clinic focused on congestive heart failure and device management.

## Nursing Units

The new inpatient nursing units allow nurses to spend more time with patients and less time collecting supplies. Each room has a patient server that holds patient care supplies. Nurses open the servers from inside the room; the servers also open from the hall, so patients are not disturbed while supplies are being restocked.

## Gift Shop

Opening later this year, the new gift shop will be conveniently located in the main lobby with a selection of cards, gifts, flowers and snacks.

## Patient Units

- 5 General Medical/Surgical Units
- Orthopedic/Neuroscience Unit
- Cancer Care Unit
- Pediatric Unit
- Medical/Surgical Stepdown Unit
- Critical Care Unit (CCU)
- CVIU (cardiovascular intermediate unit)
- Observation Unit
- Obstetric Units (pre-natal & post-natal)

## Laboratory

Set to perform approximately 1.8 million tests per year, the laboratory includes a tube system that will transport 99 percent of all lab specimens throughout the hospital quickly and allow caregivers to spend more time with patients.



2503 Maple Ave., Suite A  
Zanesville, OH 43701

CHANGE SERVICE REQUESTED

## LiveWell

is a quarterly publication of  
Genesis HealthCare System.

### Send inquiries to:

Genesis HealthCare System  
Marketing & Public Relations  
2503 Maple Ave., Suite A  
Zanesville, OH 43701  
(740) 454-5913  
Email [slacy@genesishcs.org](mailto:slacy@genesishcs.org)

---

**Matthew J. Perry**  
President & CEO

**Chris Kostoff**  
Interim Director, Marketing & Public Relations

Editor

**Nancy Ring**

Design Editor

**April Gutridge**

Designers

**Dustin Lyons**

**Jesh Folden**

Contributing Writers

**Susan Davis**

**Becky Downing**

Photographer

**Todd Yarrington** – Yarrington Studios



[genesishcs.org](http://genesishcs.org)